



GUANG YA

GR60C Series Aluminum Outward Casement Window

GR60C Series Aluminum Outward Casement Window

Product: GR60C Series aluminum outward casement window
 Profile type: Heat-insulation aluminium profiles
 Frame width: 50mm
 Glazing option: 11~40mm
 Opening style: Outward opened
 Profile thickness: 1.4mm (1.3mm、1.5mm)
 Consumption of aluminum profile: 10.97kg/m²

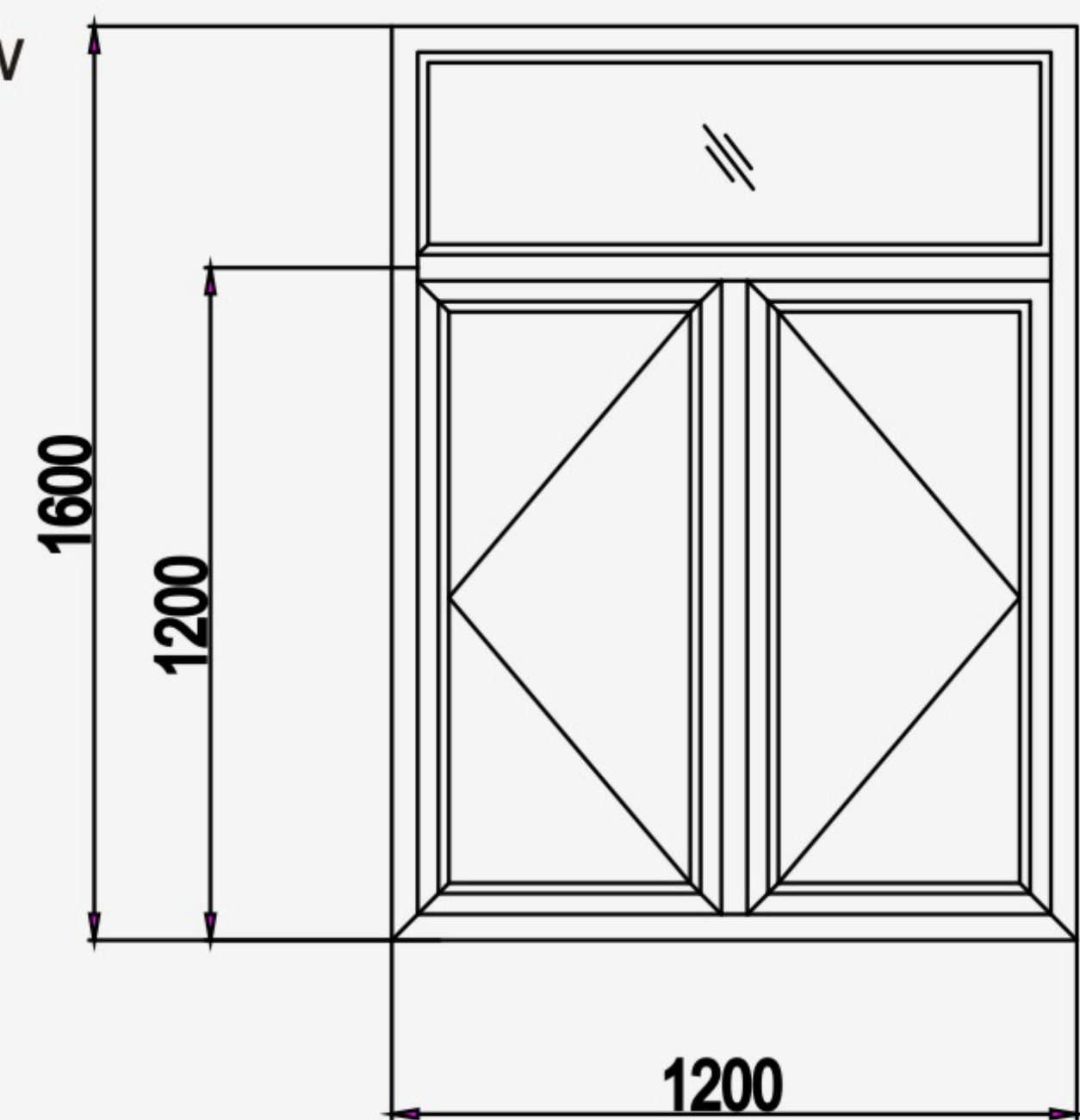

Product performance (in accordance with GB/T 8478 - 2008)

1. Wind load resistance: Grade 8 - $4500 \leq P_3 < 5000 P_a$
2. Air tightness: Grade 7 - $1.0 \geq q_1 > 0.5 m^3 / (m \cdot h)$
3. Water proof: Grade 6 - $\Delta p \geq 700 P_a$

Product features:

1. With grooves adhering to European standard and universal accessories as well as flexibility supported by sufficient profile extrusion molds.
2. This series have various product structures, can be applied to inward and outward casement windows and doors.
3. The outward casement window is equipped with indoor folding sash screen and the inward casement window is equipped with outdoor detachable screen.
4. Frame and sash are spliced with 45 degree Angle.

Accessories provided by Guangya:

Item	Price *
Hinge	¥ 13- ¥ 18/ pc
Two-bore Lock	¥ 40- ¥ 200/
Wind Bracing	¥ 10- ¥ 15/ pc

Item	Price *
Sealant	¥ 2- ¥ 5/ meter
Weather Strip	¥ 0.2- ¥ 0.5/ pc
Silicone Sealant	¥ 10- ¥ 15/ pc

* For reference only,subject to further change.



GUANG YA

GR60C Series Aluminum Outward Casement Window

GR60C Series Aluminum Outward Casement Window

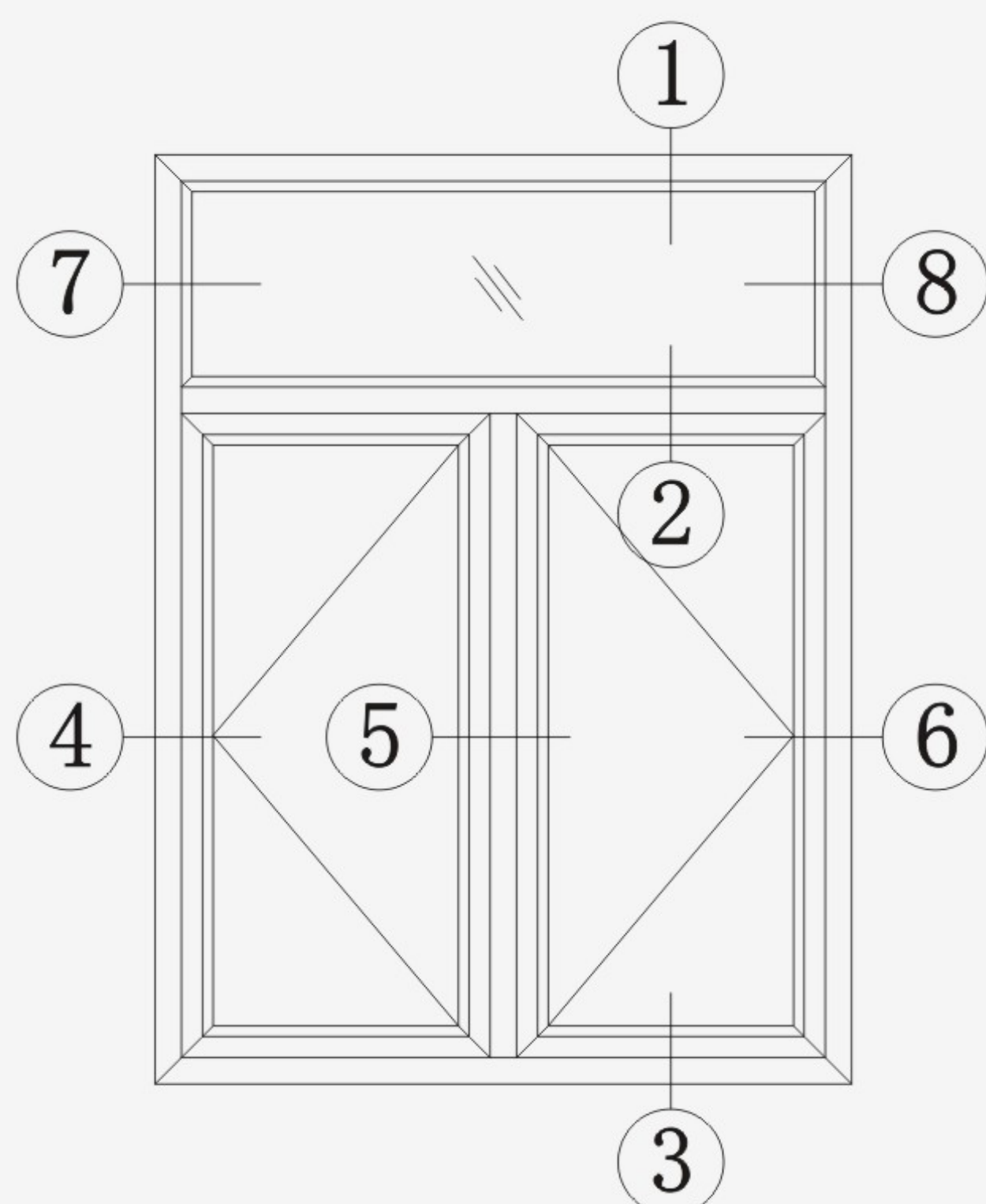

Indoor

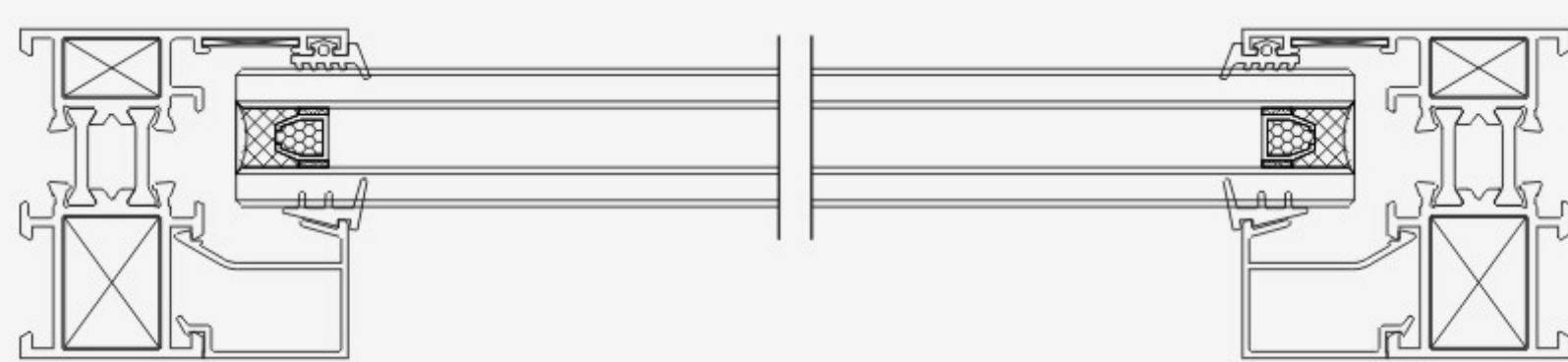

7

8

Indoor

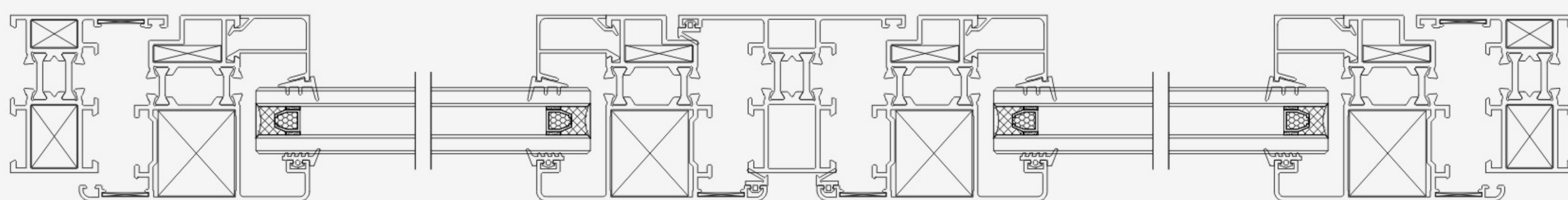

4

5

6

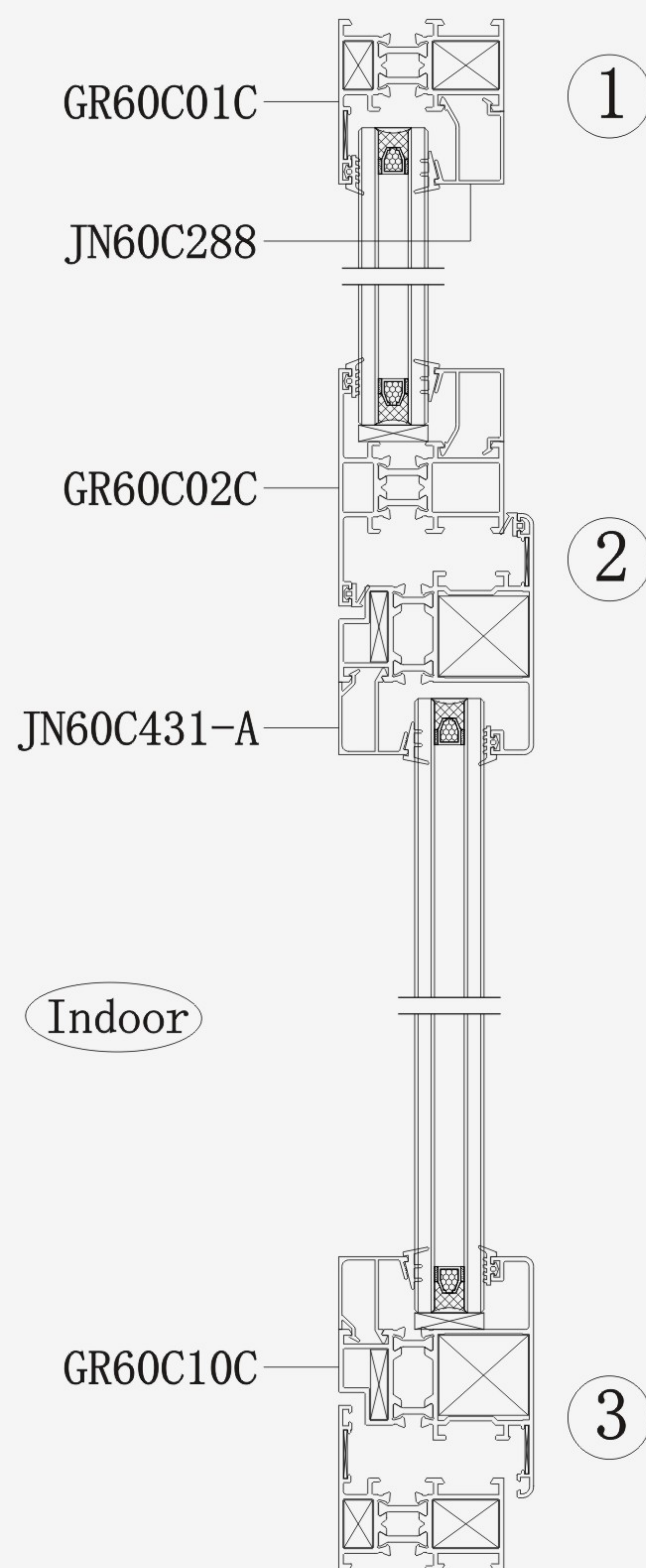

GR60C01C

1

JN60C288

GR60C02C

2

JN60C431-A

Indoor

GR60C10C

3



GUANG YA

GR60C Series Aluminum Outward Casement Window

Application	Frame	Application	Angle	Application	Mullion
DWG No.	GR60C01C	DWG No.	JN6402	DWG No.	GR60C02C
Thickness	$\delta = 1.4$	Thickness	-----	Thickness	$\delta = 1.4$
T.W.	1.049kg/m	T.W.	2.988kg/m	T.W.	1.154kg/m
<p>* Matching Angle Is JN6402. * Mullion Connector Is JN60C92.</p>				<p>* Mullion Connector Is JN60C92.</p>	
Application	Angle	Application	Out-opening Sash	Application	Angle
DWG No.	EAW6308	DWG No.	GR60C10C	DWG No.	JN5811
Thickness	$\delta = 4.0$	Thickness	$\delta = 1.4$	Thickness	$\delta = 3.0$
T.W.	3.399kg/m	T.W.	1.323kg/m	T.W.	2.878kg/m
		<p>* Matching Angle Is JN5811, EAW6308.</p>			
Application	Bead For Frame	Application	Mullion Connector	Application	Bead For Sash
DWG No.	JN60C288	DWG No.	JN60C92	DWG No.	JN60C431-A
Thickness	$\delta = 1.0$	Thickness	-----	Thickness	$\delta = 1.0$
T.W.	0.235kg/m	T.W.	1.169kg/m	T.W.	0.240kg/m
<p>* Assembled For GR60C01C, Glazed For 25mm.</p>				<p>* Assembled For GR60C01C, Glazed For 25mm.</p>	